

ITEM NO.	PART NUMBER	DESCRIPTION	QTY.
2	CMGE-0030	Hinge:Dirak-Snap-Line#18-9001.00-00015	4
3	CMGE-0140	Handle:D Shaped-Chrome#6 x 10mm	4
4	CMGE-0323	Bearing:NSK 6202-22	4
5	CMGE-1132	Foot-Disc 65mm-16mm Thread	4
6	CMGE-1134	Foot Insert Blk Nylon 16mm Suit 38mm Tube	4
7	CMGE-1329	Latch:Side Mount:Black:Southco:C3-810	2
8	CMGE-1272	Latch,Cam.Flush Ball Handle:Southco:01-23-11	1
9	CMGE-1272	Latch,Cam.Flush Ball Handle:Southco:01-23-11	1
24	SPPL-CA-BA-p18 A	Gas Bottle Tube Sleeve (PVC)	8
32	SPPL-CA-BA-p28 A	Apparatus Dryer Front Divider Rod (MESR-0004)	4
42	SPPL-CA-BA-p51 A	Door Slider Insert	4
62	CMGE-0154	S-S Piano Hinge (50mm Open)	1.5mm
63	A5-31-360-10_A5_ROD_CLF	Southco Locking Rod (A5-31-360-10)	4



TOP TRACK & ROLLER ASSEMBLY TO RETAIN CENTRE DOORS



BOTTOM TRACK & ROLLER ASSEMBLY TO RETAIN CENTRE DOORS

NOTE: RETAINER ASSEMBLY WILL ALLOW DOOR TO BI-FOLD WHEN OPENING

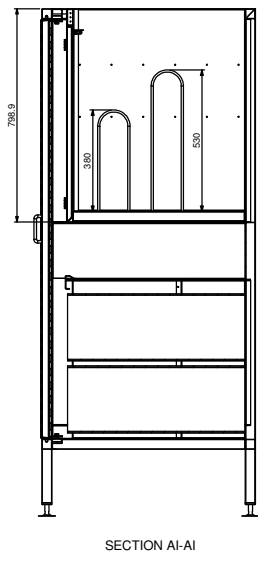
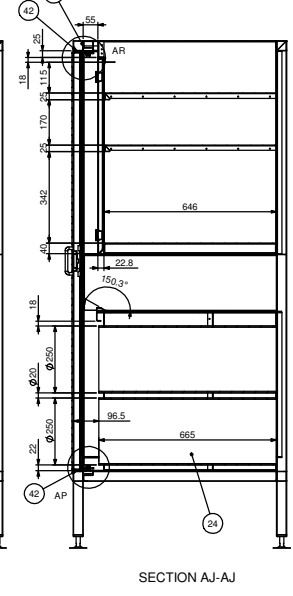
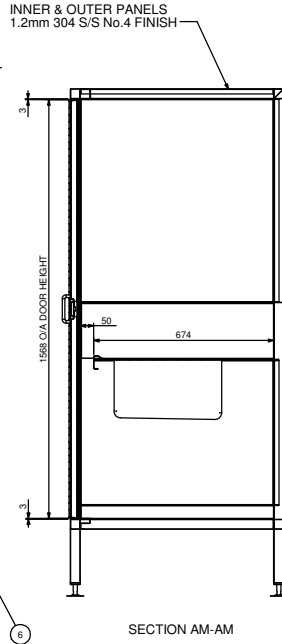
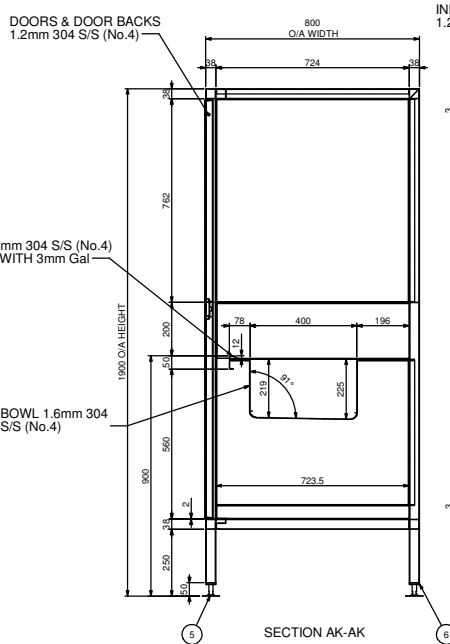
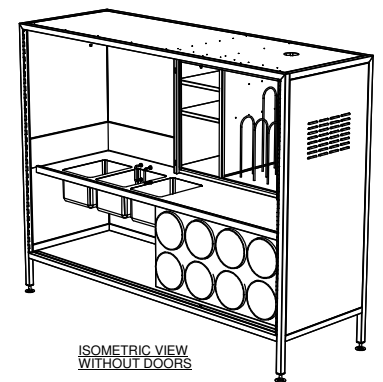

STODDART
MANUFACTURING
No. 6
140, Anderson St. Southcoast, WA 6244 100
Phone (817) 2445 2011 Fax (817) 2344 1000
Email: sales@stoddart.com.au
Quality in stainless steel!

REV/VER	REVISED BY	DATE	REVISION DESCRIPTION	STATUS
A1	S Ellis	18/06/2012	Drawings added to top/bottom side of cabinet. Minor changes to parts p34, 35, 36, 37, 38, 39, 40, 41, 44, 46, 47.	For Manufacture
A2	S Ellis	28/11/2014		

DATE	DESIGNED	DRAWN	CHECKED	APPROVED	TITLE
19/06/2009	S.S.	S.S.	S.S.	S.S.	BA Station Cupboard

Copyright Reserved 1986-2007 SCALE: 1:10
 PROJECT: SPPL-CA-BA-001 A2
 DRAWING NO: 1
 ISSUE: 1